

FULL BOTTLE WASHER - DRYER

HYDRA



HYDRA 1000

HYDRA 2000

HYDRA 3000



Bottling technology
www.costral.fr

**The HYDRA washer/dryer washes and dries full bottles.
Bottles processed in this way can be labelled and packed in boxes right away.**

WASHING

The conveyor channels the bottle and places it in a star wheel to turn as it touches the three brushes. As the bottle is in contact with the brushes, they turn to ensure the perfect washing. Changes in bottle size require a simple replacing of the star wheel.

DRYING

Bottles are then conveyed to the drying zone where they are dried with hot air produced by the turbines in the tunnel. To ensure the complete drying, the bottle stands only partially on the conveyor so that it turns on itself.

TECHNICAL CHARACTERISTICS

- Frame and all parts in contact with water in stainless steel.
- Bottle maintained with a 8-branch star during the washing.
- Bottle washed with three rotary brushes
- Solenoid valve
- **Base and cap/cork brushed**
(2 fixed base brushes – 1 cap/cork brush)
- Bottle dried in a tunnel **with hot air produced by turbines** mounted on the machine's frame
- Bottles come out dry on the conveyor chain
- Two electronic variable speed drivers (conveyor and bottle selection star) guarantee perfect synchronizing with the other machines on the line.



3 rotary washing brushes

- Low voltage centralized control panel
- 4-line screen displays data from the bottle counters (total counter, daily counter, rate etc.)
- **Soundproofing** (acoustic insulation)
- **Bottle detection** at the inlet
- **Anti blocking** device mechanism at the outlet

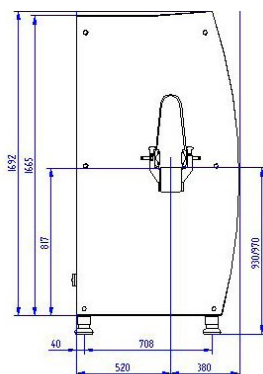
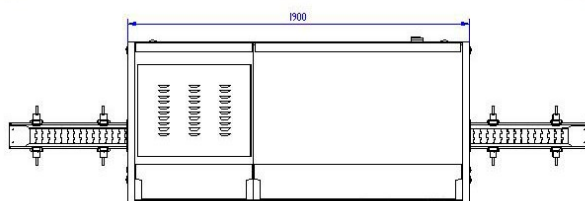
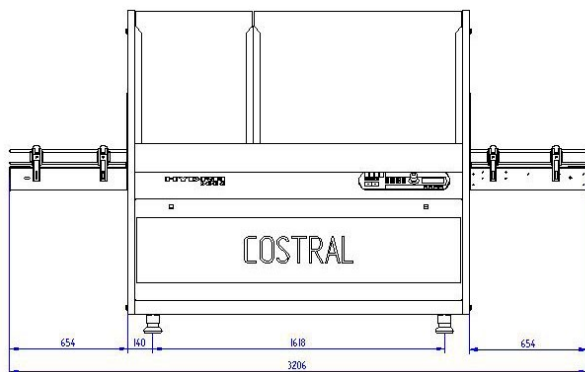

Modèle	HYDRA 1000	HYDRA 2000	HYDRA 3000
Cadence (enb/h)	500 à 1200	500 à 2200	500 à 3000
Nombre de brosses rotatives de lavage	3	3	3
Nombre de turbines de séchage	1	2	3
L (en mm hors convoyeur)	1600	1900	2300
l(en mm)	900	900	900
h (enmm)	1850	1850	1850
Poids (en kg)	505	570	660
Puissance des turbines	5,5 kw	2x3 kw	3x3 kw